



Château de Clérac, also known as *Château de l'Espie*, is just 35 mins north of Bordeaux. It's the ideal get-away for those who want to experience the rich flavors of this extraordinary region. Surrounded by its 9 hectares (22 acres) of woods and fields, this impressive building stands testament to days and lifestyles long gone by.

Prices

Weekend & Weekly Rental

Rental of entire Château (sleeps up to 16), self-catering basis

300-750 Euros for weekend rental (Fri-Sun) depending on season

1200-3200 Euros for weekly rental (Sat-Sat) depending on season

Bed & Breakfast

Between 35 and 75 Euros depending on season.

Wine Tasting

We hold residential wine weekends (including visits to various châteaux) throughout the year. Please call us or see our website for more details.



Nearest Airports

Bordeaux International Airport (BOD), approximately 45mins (60km) to the south

Bergerac Airport (EGC) - approx 60mins

Angoulême Airport (ANG) - approx 60mins

Périgueux Airport (PGX) - approx 90mins

www.chateau-de-clerac.com

Château de Clérac 17270 Clérac France

Tel: + 33.546.70.65.02

Mobile: + 44.7981.230.135

enquiries@chateau-de-clerac.com

Château de Clérac



www.chateau-de-clerac.com

-  *Weekly Rental*
-  *Weekend Rental*
-  *Bed & Breakfast*
-  *Painting Courses*
-  *Wine Tasting*

Château de Clérac

17270 Clérac, France

Tel: + 33.546.70.65.02

Mobile: + 44.7981.230.135

enquiries@chateau-de-clerac.com

Ground Floor

As you walk through the doorway of the West wing you enter the vast main lounge (63m²) which has a 2m high woodburning stone



the Lounge

fireplace, comfortable leather sofas, TV (Satellite), DVD and HiFi. The kitchen is just off the main lounge and has all the standard amenities - microwave, washing machine, dishwasher, gas cooker, fridge, freezer and a number of smaller kitchen appliances (toaster, coffee maker, kettle, etc).



the Dining Room

There is a formal dining room (35m²) which can be used to enjoy the magnificent wine and food from this famous region.

The drawing room (32m²) contains the original glass chandelier and has an impressive mirror and fireplace - an ideal place to relax, listen to music or watch a film (it has TV, VCR & HiFi).



the Office

The downstairs gallery shows the original floor tiling. The office area provides leisure information, telephone, internet & WiFi.



Downstairs Gallery

First Floor

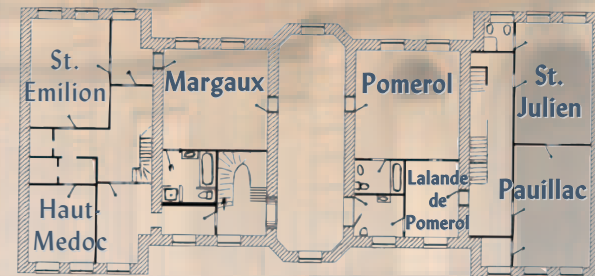

All bedrooms and ensuite are situated on the 1st floor. Each bedroom has ample space for an extra bed or baby cot (available on request).

Pomerol & Margaux both have full ensuite facilities, including bath.



Pomerol



Margaux

St. Julien & Pauillac also have full ensuite facilities, with Pauillac boasting a hydro-massage shower.



St. Julien



Pauillac

St. Emilion & Haut-Medoc, in the East Wing are more contemporary in style.



St. Emilion



Haut-Medoc



Upstairs Gallery